



**STADUR**  
Innovation und Systemlösungen

Made  
in  
Germany



**GARANTIE  
URKUNDE**

Subject to the  
observance of our processing and  
storage instructions,  
terms of warranty, and General Terms  
and Conditions of Business  
we grant for the bonding  
of our products

**10 Years Guarantee**

**STADUR**  
Innovation und Systemlösungen

Stadur Produktion GmbH & Co. KG  
Ottensheim 24 • D-22716 Hamburg  
Telefon +49 (0) 4144 254-0 • Telefax +49 (0) 4144 254 100  
E-Mail: stadur@stadur.com • www.stadur.com

# Stadur Fassadenelement Fapatec

**The Glass Composite Board**

# Product Information

## Stadur Fapatec Composite Element for Facades



### Description:

Stadur Fapatec composite elements for facades consist of an extruded polystyrene core and facings of tempered safety glass, laminated safety glass, aluminium, steel or PVC.



### Properties:

- very good thermal insulation
- optimal sound suppression
- UV- Endurance
- easy to clean
- ageing and temperature resistant
- high stability



### Facings:

Stadur Fapatec composite elements for facades can be produced with tempered or laminated safety glass in 6, 8 or 10 mm thicknesses. A multitude of non-heavy-metal enamel colours according to the RAL/NCS range is available. Reverse side 1.5 or 2.0 mm hard-PVC similar to RAL 9016, 1.5 or 2.0 mm aluminium according to RAL/NCS colours, anodised, blank or with steel sheeting. Other surfaces available on request.



### Core material:

Extruded polystyrene foam, CFC for CO<sub>2</sub> foamed, B1 in accordance with DIN 4102, low vapour permeability, lowest water absorption. Other core materials, e.g. mineral wool or honeycomb construction materials are available on request.



### Overall thickness:

The overall thickness depends on the individual customer needs and can be chosen in millimetre increments anywhere from 10 up to 120 mm. Our standard thickness tolerance is +/- 0.8 mm.



### Formats:

Any format from 400 x 400 mm up to 4000 x 2000 mm can be produced. The tolerances in length and width depend on the format of the glass and account for +/- 4 mm.



### U-value:

The U-value depends on the used material thicknesses.



### Special elements:

Stadur Fapatec composite elements for facades can be produced as a cassette element with a mineral wool core.

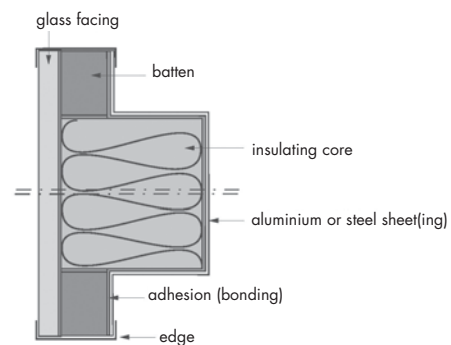
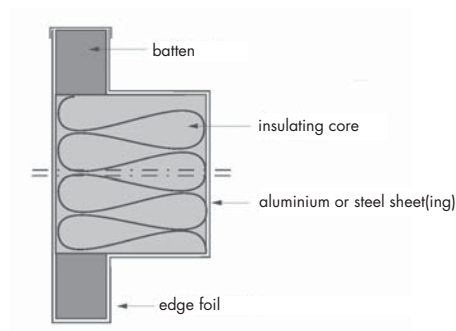

Technical changes with reservation.